

ESD1Z Series

ESD Protection Diodes

Features

- Low clamping voltage
- Low leakage

PINNING

PIN	DESCRIPTION
1	Cathode
2	Anode

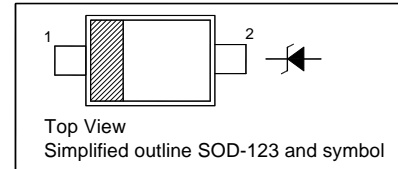

Absolute Maximum Ratings ($T_a = 25^\circ\text{C}$)

Parameter	Symbol	Value	Unit
Peak Pulse Power ($t_p = 8/20 \mu\text{s}$)	P_{PK}	200	W
ESD (IEC61000-4-2) Air Contact	V_{ESD}	± 30	KV
Operating Junction Temperature	T_j	150	$^\circ\text{C}$
Storage Temperature Range	T_{stg}	- 55 to + 150	$^\circ\text{C}$

Characteristics at $T_a = 25^\circ\text{C}$

Type	Reverse Stand-off Voltage	Reverse Current	Breakdown Voltage			Clamping Voltage	
	V_{RWM}	I_R at V_{RWM}	V_{BR}		V_C	at I_{PP}	
	Max. (V)	Max. (μA)	Min.(V)	Max.(V)	mA	Max.(V)	A
ESD1Z5V0	5	400	6.4	7	10	9.2	21.7
ESD1Z12	12	2.5	13.3	14.7	1	19.9	10.1

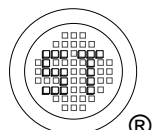

ESD1Z Series

Electrical Characteristics Curves

Fig 1. Pulse Waveform

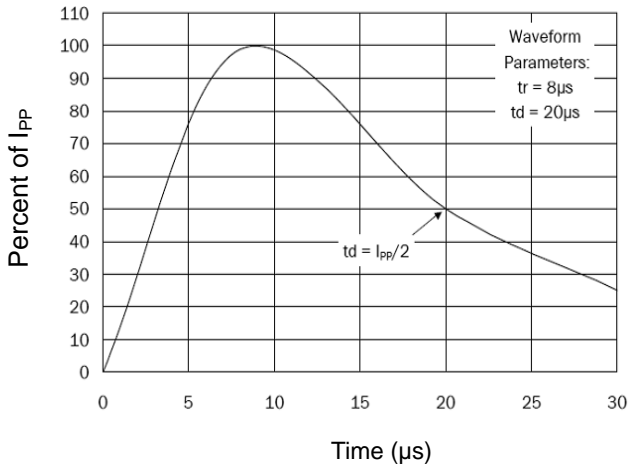

Fig 2. Power Derating Curve

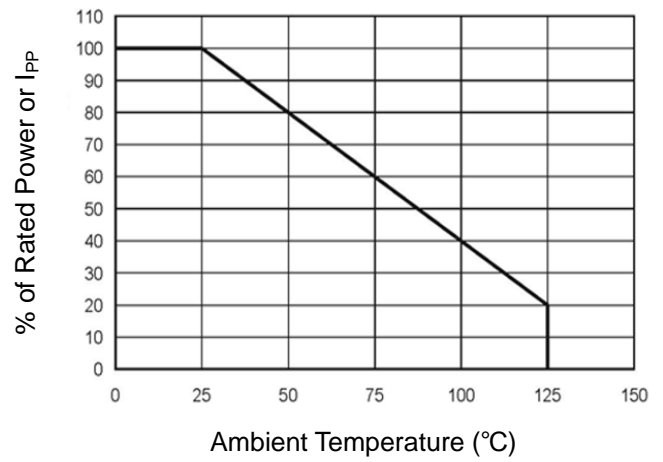

Fig 3. Clamping Voltage Curve

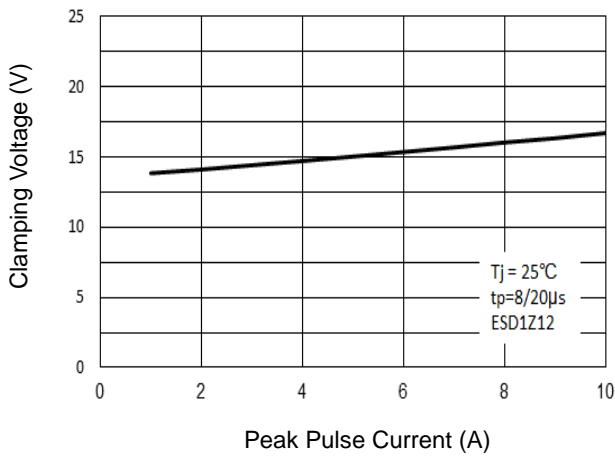

Fig 4. Junction Capacitance

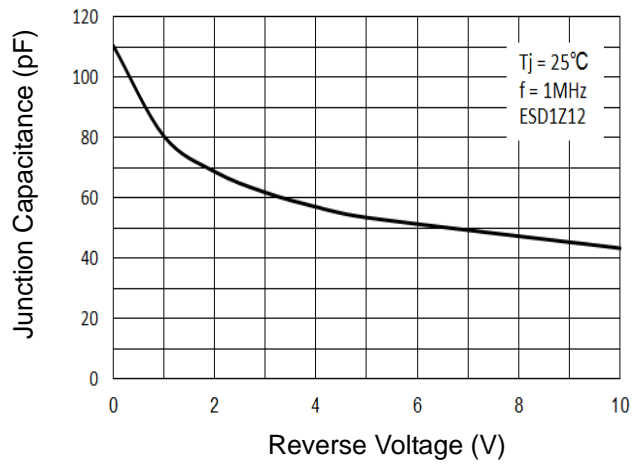
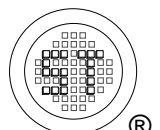
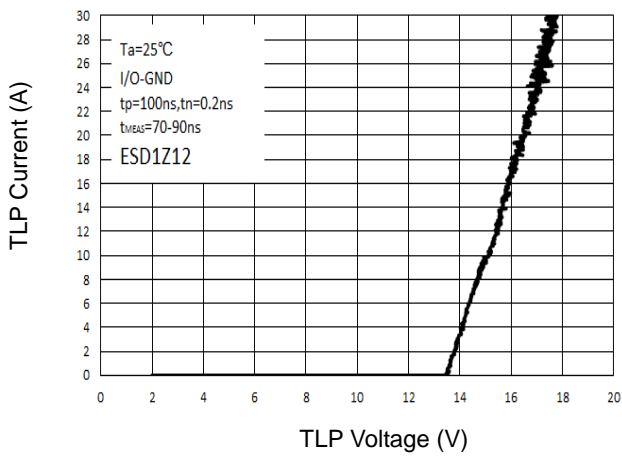

Fig. 5 TLP Curve



ESD1Z Series

PACKAGE OUTLINE

Plastic surface mounted package; 2 leads

SOD-123

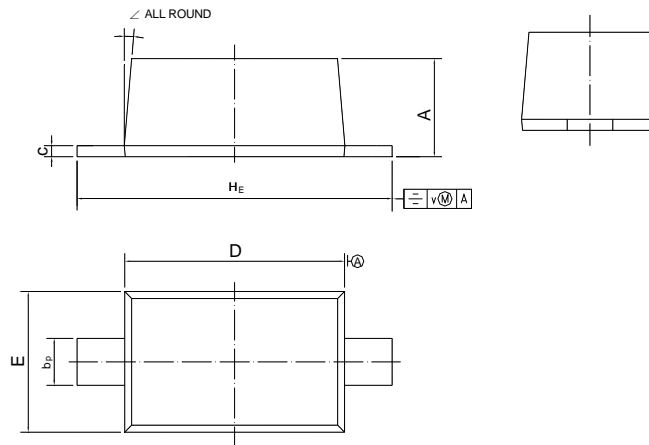

UNIT	A	b _p	c	D	E	H _E	v	∠
mm	1.15 1.05	0.6 0.5	0.135 0.100	2.7 2.6	1.65 1.55	3.85 3.55	0.2	5°

Recommended Soldering Footprint

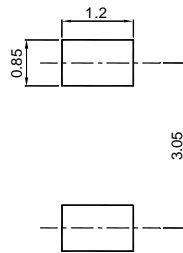

Packing information

Package	Tape Width (mm)	Pitch		Reel Size		Per Reel Packing Quantity
		mm	(inch)	mm	(inch)	
SOD-123	8	4 ± 0.1	0.157 ± 0.004	178	7	3,000

Marking information

" ** " = Part No.

Type	Marking	Type	Marking
ESD1Z5V0	1U	ESD1Z12	2U

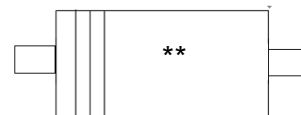

" III " = Cathode line

Font type: Arial

Disclaimer: Our company reserve the right to make modifications, enhancements, improvements, corrections or other changes to improve product design, functions and reliability, anytime without notice. Semtech Electronics Limited makes no warranties, representations or warranties regarding the suitability of its products for any particular purpose, and does not accept any liability arising from the application or use of any product or circuit such as: Apply to medical, military, aircraft, space or life support equipment and expressly waive any and all liability, including but not limited to special, consequential or collateral damage.

